

IF IN DOUBT ASK

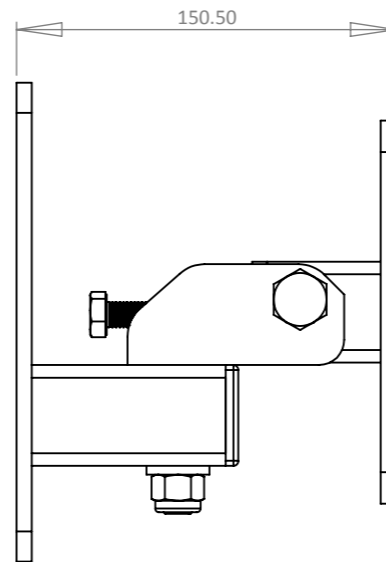
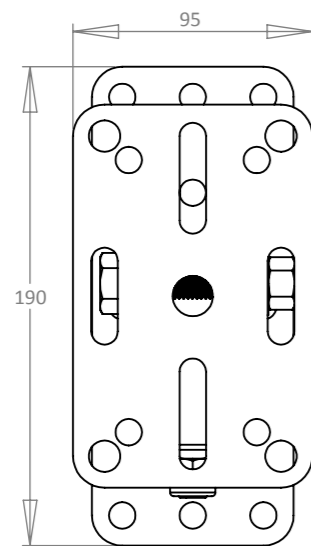
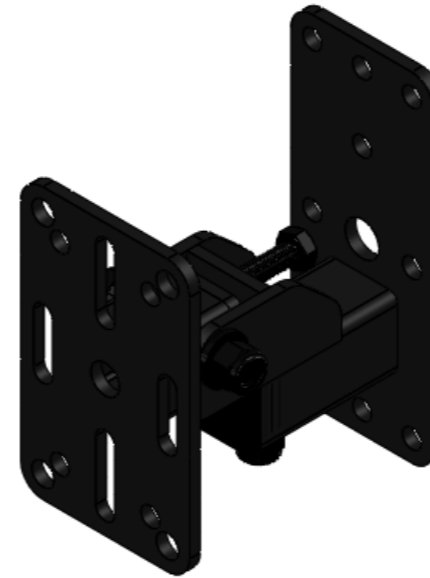
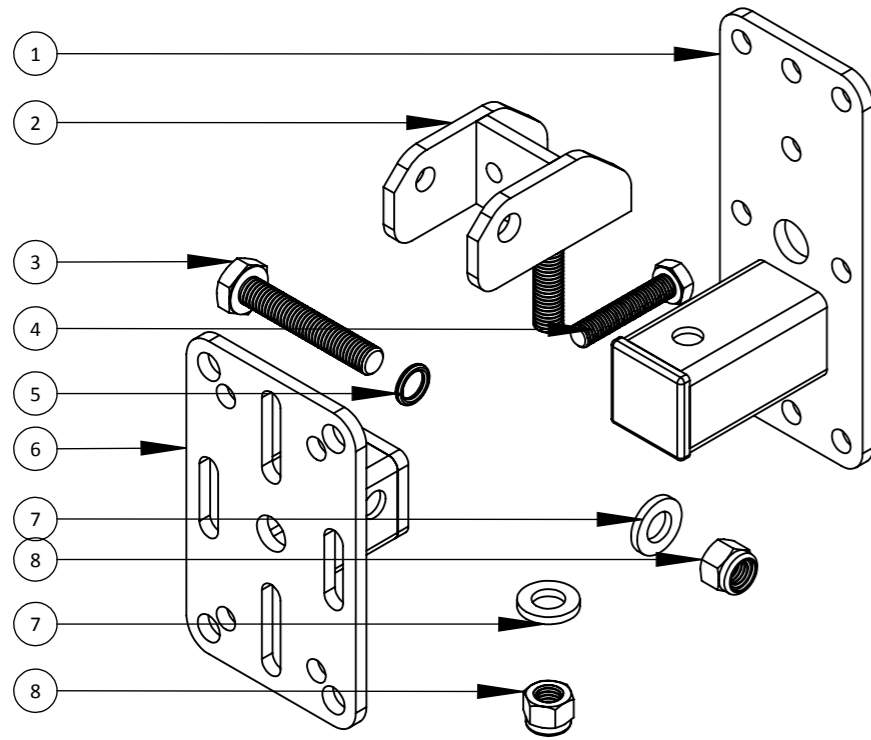

DEBUR AND BREAK SHARP EDGES DO NOT SCALE DRAWING

UNLESS OTHERWISE SPECIFIED:  
DIMENSIONS ARE IN MILLIMETRES  
TOLERANCES:  
LINEAR: xx  
ANGULAR: xx

TITLE: WHH100-B

MATERIAL: AS SHOWN

PART NO: WHH100-B

FINISH: AS SHOWN

Sheet 1 of 1

WEIGHT: 313.72

SCALE: 1:3

A3

	NAME	SIGNED	DATE
DRAWN			
CHK'D			
APPV'D			

Comments:



All rights reserved. This drawing and all information contained herein is the property of Powerdrive Drum Company Ltd and as such may not be copied or reproduced, in whole or in part, without prior written agreement.

PART NO.	ITEM NO.	DESCRIPTION	QTY.
3001-300	1	Arm WHH A100	1
1050-500		Plate Wall HD M818	1
1020-332		Box Section 40mm x 40mm WHH M1191A	1
2011-270		End Cap 40mm Sq B237	1
3021-200	2	Swivel & Tilt Unit HD ST100	1
1000-200		Angle Component 40mm x 40mm x 6mm M10 BC M100	1
1050-600		Plate Side H/D Swivel & Tilt Unit M1177	1
1050-601		Plate Side H/D Swivel & Tilt Unit M12	1
7031-373		Set Screw M12 x 65mm Hex Head B351	1
7031-374	3	Set Screw M12 x 70mm Hex Head B352	1
7031-353	4	Set Screw M10 x 50mm Hex Head B312	1
7041-401	5	Washer M12 Spring Sq Section B222	1
3011-304	6	Plate Type 100 Welded to 40mm Sq x 3mm Blanked M1234	1
1050-706		Plate 100 Type M817	1
1050-000		Plate Blanking 40mm Sq M1541	1
2040-705		Pillar Tilter 40mm Sq x 3mm M688	1
7041-400	7	Washer M12 Thick Type B328	2
7011-400	8	Nut M12 Nylon Insert Thin Type B360	2